

SCLAKGEAR UNIVERSAL BLUETOOTH Ref. 1086/22

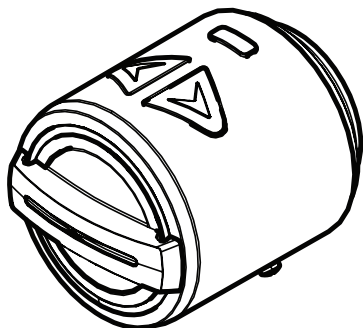

INSTALLATION HANDBOOK



1. GENERAL DESCRIPTION

The SCLAK Gear Universal Bluetooth Ref. 1086/22 is an electric knob with an elegant and modern design. The device is compatible with all euro cylinder locks for both traditional and armoured doors.

The SCLAK Gear works via Bluetooth 4.0 technology with all smartphones running iOS 8 or later or Android 4.3 or later. The device is managed from a smartphone via the dedicated Sclak app. For added convenience, in addition to the app, the door can also be opened or closed from the inside by pressing the relevant buttons on the Sclak Gear. Its ease of installation and use makes it the ideal solution for the front door of your home or a room in a tourist facility.

2. PACKAGE CONTENTS

- SCLAK Gear Universal Bluetooth Ref. 1086/22
- Card with activation code
- 2 rechargeable lithium batteries 3.7V--- ICR17335J (inserted in the device)
- 2 Locking screws for the outer casing
- TSP screw M4X8 mm UNI7688
- Conical serrated washer 4 mm DIN 6798 V
- USB-C adapter
- Installation handbook

3. DESCRIPTION OF PARTS

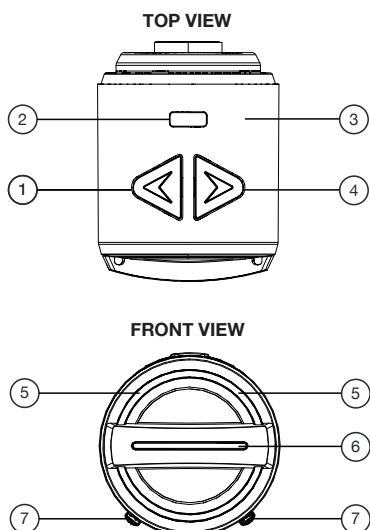

1. Lock opening button
2. MicroUSB port for battery charging
3. Outer casing
4. Lock closing button
5. Signalling LED
6. Top cover
7. Locking screws

4. REPLACEMENT OF A SCLAK GEAR REF. 1086/22

WARNING! Urmet S.p.a. denies all liability for damage or malfunctions of any kind arising from or in any way connected with installations carried out in ways different from or contrary to these instructions or by unskilled personnel. This exclusion of liability also extends to the warranty period of the product.

The following are the steps to replace a Sclak Gear according to the type of door and Gear accessories used.

TRADITIONAL OR ARMoured DOOR WITH GEAR ACCESSORIES FOR EURO CYLINDER LOCK INSTALLED REF. 1086/25

1. Using the hexagonal Allen key (included with Gear accessories Ref. 1086/25), loosen the grub screw (M3x6) until the Sclak Gear is loose.

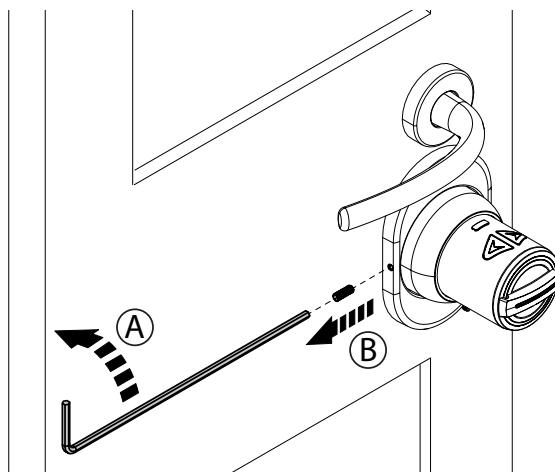

2. Remove the Sclak Gear to be replaced from the bracket.

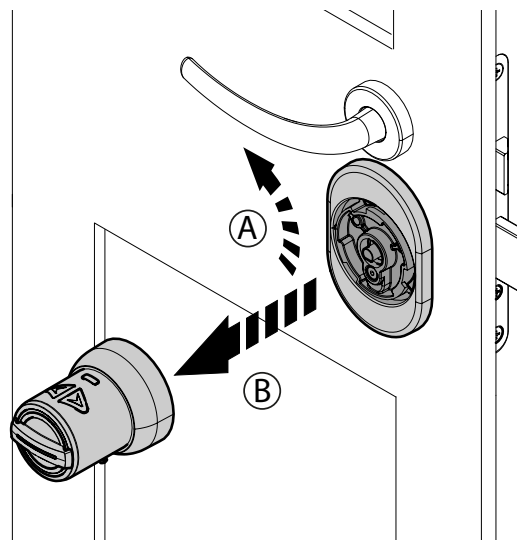

3. Rotate the device and on the inside, unscrew the lower M4x8 screw and the serrated washer with a screwdriver to separate the cylinder lock adapter from the Sclak Gear to be removed.

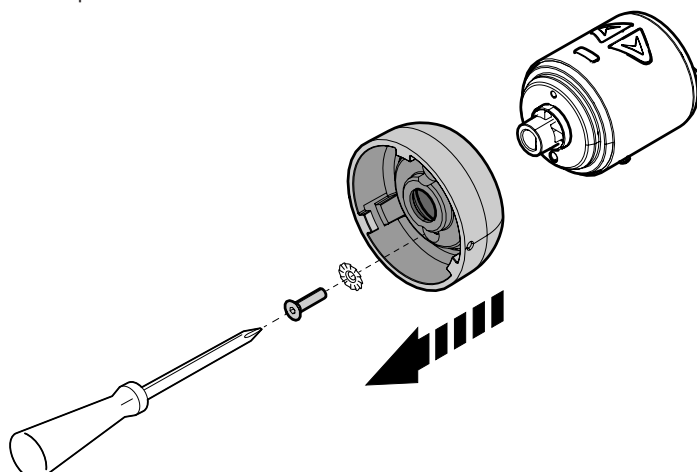

4. Remove the door cylinder lock attachment bush from the Sclak Gear.

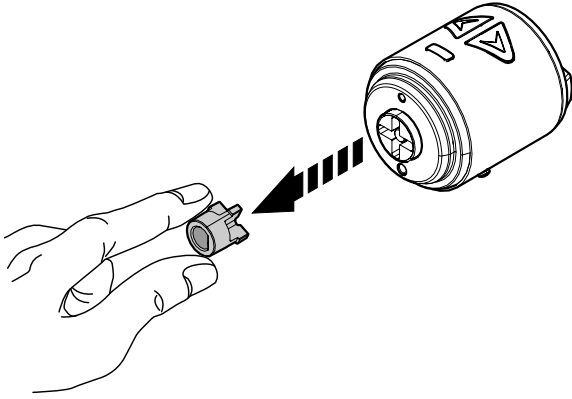

5. On the new Sclak Gear, insert the bush and attach the device to the cylinder lock adapter by screwing the lower M4X8 screw and the serrated washer into the inside with a screwdriver.

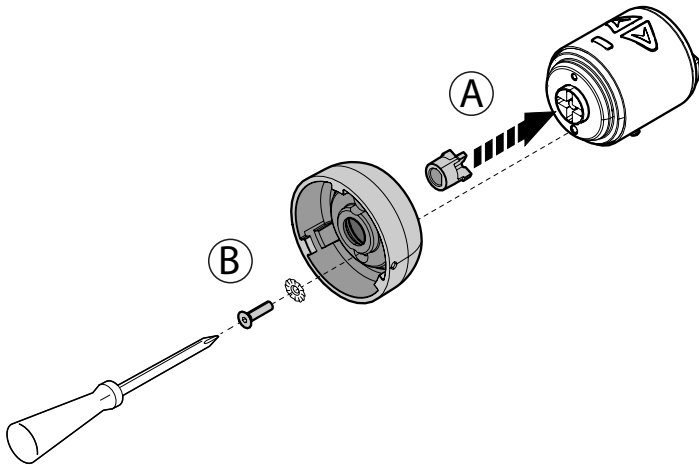

6. Place the new Sclak Gear on the bracket and screw the grub screw into the left side hole to secure the device.

TRADITIONAL OR ARMoured DOOR WITH GEAR ACCESSORIES FOR EURO CYLINDER LOCK INSTALLED REF. 1086/26

1. Using the 2 mm hexagonal Allen key (included with Gear accessories Ref. 1086/26), loosen the grub screws in the 4 adapter holes (2 upper and 2 lower) per cylinder lock until the Sclak Gear is loosened.

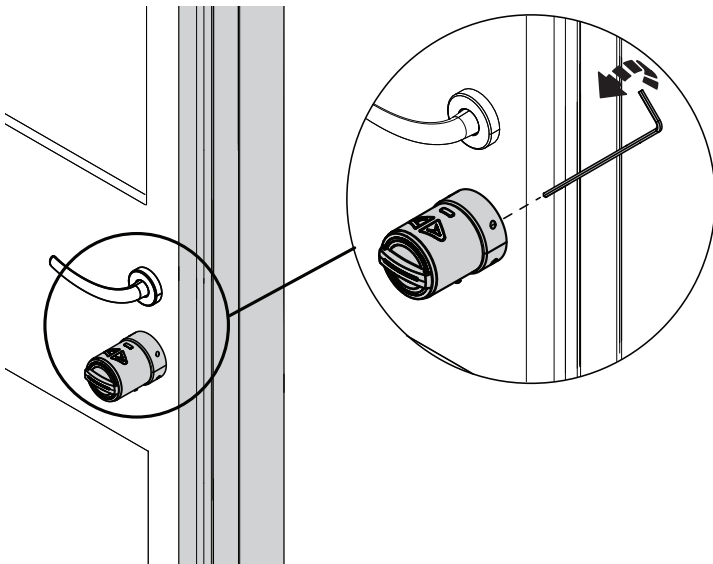

2. Remove the Sclak Gear to be replaced from the cylinder lock on the door.

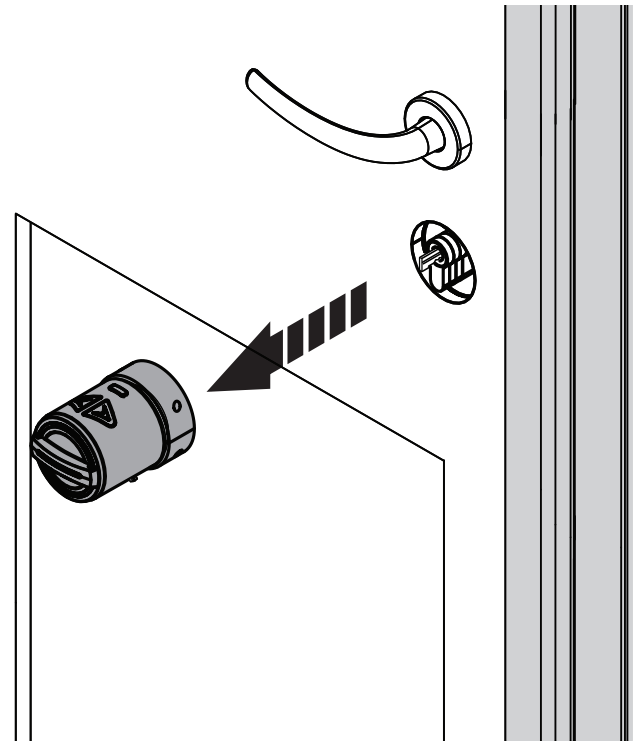

3. Rotate the device and on the inside, unscrew the M3x8 screw and the conical serrated washer with a screwdriver to separate the cylinder lock adapter from the Sclak Gear to be removed.

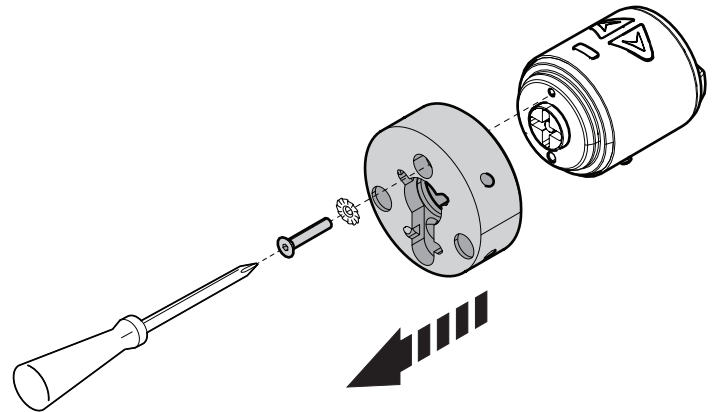

4. On the new Sclak Gear attach to the cylinder lock adapter by screwing in the screw and the conical serrated washer on the inside.

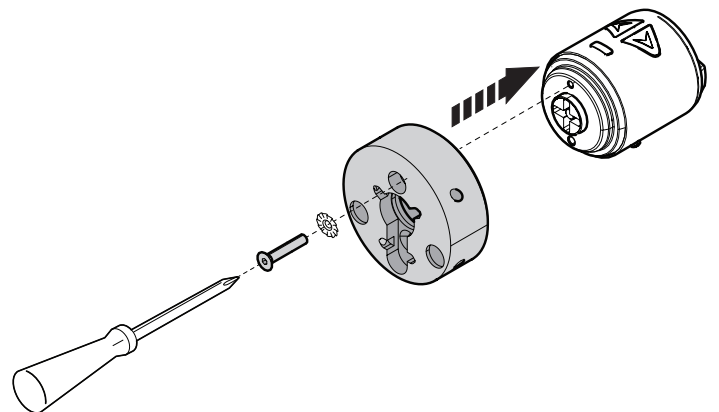

5. Place the new Sclak Gear on the door cylinder lock and screw the 4 grub screws in the holes on the cylinder lock adapter to lock the device.

5. ACTIVATION AND CONFIGURATION OF THE DEVICE VIA SCLAK APP

In order to use the device, it must be configured; without configuration, pressing the buttons will not operate the motor that allows the door to open and close, and the device will emit a double BEEP. To proceed with the configuration of the SCLAK Gear Bluetooth Ref. 1086/22 it is necessary to download the **Urmot SCLAK app**, available from the *Apple store* (iOS) or the *Play Store* (Android), to a Smartphone connected to the Internet via its own mobile phone data connection or via WiFi.

You can download the app to your smartphone by scanning the following QR code.



After downloading and installing the app, follow the device activation procedure indicated on the Urmot SCLAK app. For more details on activating the SCLAK Gear Bluetooth Ref. 1086/22 refer to the SCLAK website under “**Products / Installation and activation / Activate SCLAK GEAR / See instructions**” or scan the following QR Code with your smartphone camera.



6. RECHARGE AND REPLACEMENT OF BATTERIES

BATTERY CHARGER

When the device's batteries reach 10 per cent charge, a BEEP is emitted when either button is pressed to indicate low battery charge. When the batteries finally run out when the buttons are pressed, the device will not perform any action.

CAUTION! If batteries are not charged, they will begin to deteriorate until they become unrecoverable and a battery replacement will be necessary.

Low battery warning is also signalled by the Sclak app.

To charge the battery, remove the rubber cap and connect a USB cable to the microUSB port (depending on the type of cable you have, you may need to use the adapter provided) of the Sclak Gear, the device emits a BEEP and the LEDs light up with a flashing light. Recharging the batteries can take up to 8/9 hours. When charging is complete, the device beeps 3 times and the LEDs go out. During charging, the device tests the batteries; if the batteries are damaged, the Gear will emit 6 short BEEPs every 30 seconds. In this case, the batteries must be replaced.

If the device is not to be used for a few months, it is recommended that the batteries be fully recharged in order to avoid over-discharge with consequent deterioration of the batteries.

WARNING ! The top cover can be used temporarily as a handle for manual opening in the event of low batteries.

REPLACING THE BATTERIES

If the device no longer charges, the batteries may have deteriorated and need to be replaced.

Battery replacement must be carried out by qualified personnel. Batteries must be replaced with the same model, replacement Ref. 1086/652 (rechargeable lithium batteries ICR17335J 3.7V 700mAh), following the correct polarity. The procedure for replacing the batteries is described below.

1. Following the steps described in the previous chapter, depending on the Gear accessories installed on the door, remove the Sclak Gear from the door.
2. Separate the Sclak Gear from the cylinder lock adapter.
3. Insert a screwdriver or pointed tool into one of the two holes in the top cover of the device
4. Lever downwards with the screwdriver to push the cover upwards.

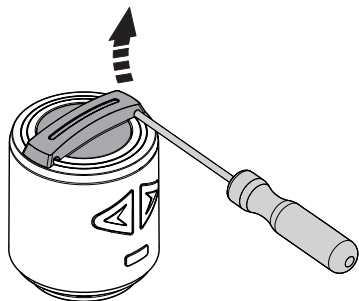

5. Perform the same operation in the other hole in the cover.
6. Remove the cover from the Sclak Gear.

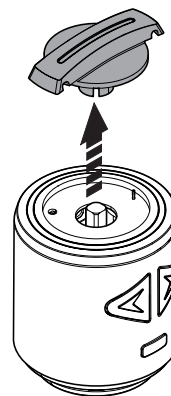

7. Rotate the device and remove the 2 locking screws that secure the outer casing of the device.

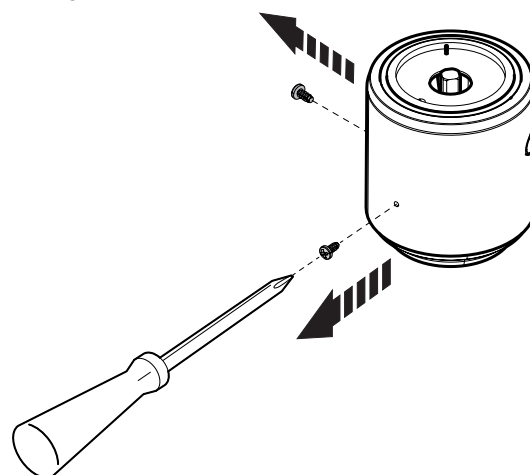

8. Pull up the outer casing to remove it and access the battery compartment.

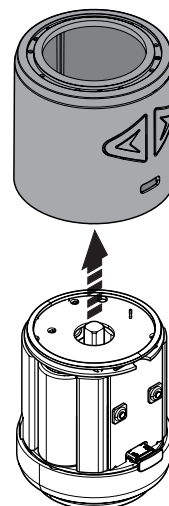

9. Remove damaged batteries by prying upwards with a screwdriver or pointed tool at the bottom of the battery compartment.

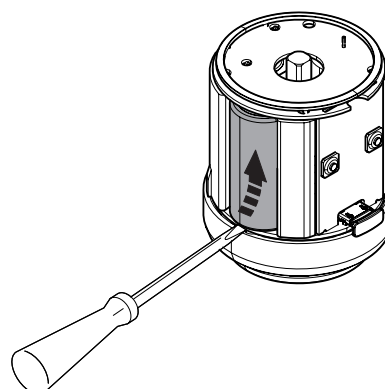

10. Remove damaged batteries from the side.

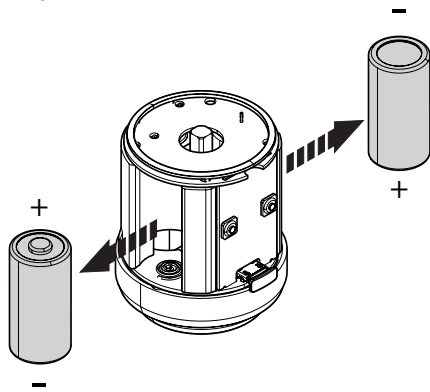

11. Insert the new batteries into the battery compartment, observing the correct polarity.

WARNING! Risk of explosion if batteries are replaced with a type other than the one indicated. Dispose of used batteries according to local regulations.

12. Reinsert the outer casing on the device.

13. Re-insert and tighten the 2 locking screws to secure the outer casing of the device.

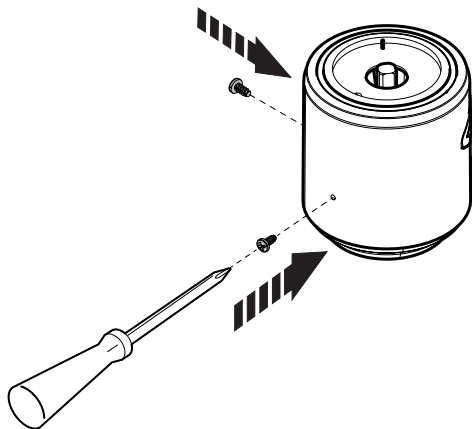

14. Reinsert the top cover on the Sclak Gear.

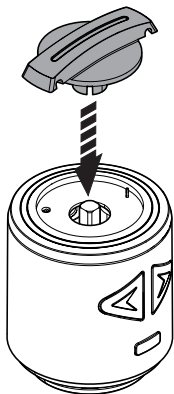



15. Refit the Sclak Gear to the cylinder lock adapter.

16. Refit the Sclak Gear to the door according to the Gear accessories installed.

7. TECHNICAL SPECIFICATIONS

Power supply: **2 rechargeable lithium batteries 3.7V --- 700mAh type ICR17335J**
Battery autonomy:.....**with 10 activations per day 3 months**
(in the indicated temperature range: 5° ÷ 35°C)
Connection:.....**Bluetooth 4.0 or later**
Frequency band:.....**2402 MHz ÷ 2480 MHz**
RF output power (Max):.....**3.4 dBm**
Protection rating of casings:.....**IP30**
Operating temperature:.....**5° ÷ 35°C**
Sizes (LxAxP):**98 x 120 x 30 mm**

8. SYMBOL LEGEND

Symbol	Explanation
---	Continuous supply voltage
 	Refer to the device installation manual

9. EU DECLARATION OF CONFORMITY SIMPLIFIED

The manufacturer, URMET S.p.A., declares that the type of radio equipment: **SCLAKGEAR UNIVERSAL BLUETOOTH Ref. 1086/22** complies with Directive 2014/53/EU.
The full text of the EU Declaration of Conformity is available at: www.urmet.com



DIRECTIVE 2012/19/EU OF THE EUROPEAN PARLIAMENT AND OF THE COUNCIL of 4 July 2012 on waste electrical and electronic equipment (WEEE)

The symbol of the crossed out waste bin on the product and its packaging indicates that at the end of its useful life, the product must be disposed of separately from other waste. Therefore, the user must take the equipment at the end of its service life to the appropriate municipal separate collection centres for electrotechnical and electronic waste. As an alternative to self-management, it is possible to hand over the equipment you wish to dispose of to the retailer when purchasing new equipment of an equivalent type. Retailers of electronic products with a sales area of at least 400 m² can also deliver electronic products for disposal with a maximum size of less than 25 cm free of charge, with no obligation to purchase. The suitable recycling for a further conveyance of the dismantled equipment, to recycling, to treatment and to environmentally compatible disposal contributes to avoid possible negative effects on the environment and on health and promotes the re-use and/or recycling of materials, of which the equipment is made.

Pour le notice d'installation en français, scannez le QR code suivant avec l'appareil photo de votre smartphone ou tablette.

Para el folleto de instalación en español, escanea el siguiente código QR con la cámara de tu smartphone o tablet.

Für das deutschsprachige Installationsheft scannen Sie den folgenden QR-Code mit der Kamera Ihres Smartphones oder Tablets.

Voor het Nederlandstalige installatieboekje scant u onderstaande QR-code met de camera van uw smartphone of tablet.

For det norskspråklige installasjonsheftet, skann følgende QR-kode med ditt smarttelefon- eller nettbrettkamera.



DS1086-021A

URMET S.p.A.
10154 TORINO (ITALY)
VIA BOLOGNA 188/C
Telef. +39 011.24.00.000 (AUT. ANS.)
Fax +39 011.24.00.300 - 323

urmet

Technical area
customer service +39 011.23.39.810
<http://www.urmet.com>
e-mail: sclak.support@urmet.com

LBT21319

MADE IN ITALY